

Date	Rev. date	Work nr.	Drw. nr.	Rev.
Drawn by Ruukki	Rev.	N29/S05	-	
Scale 1:2	Building		File nr. P2021/001-00035	

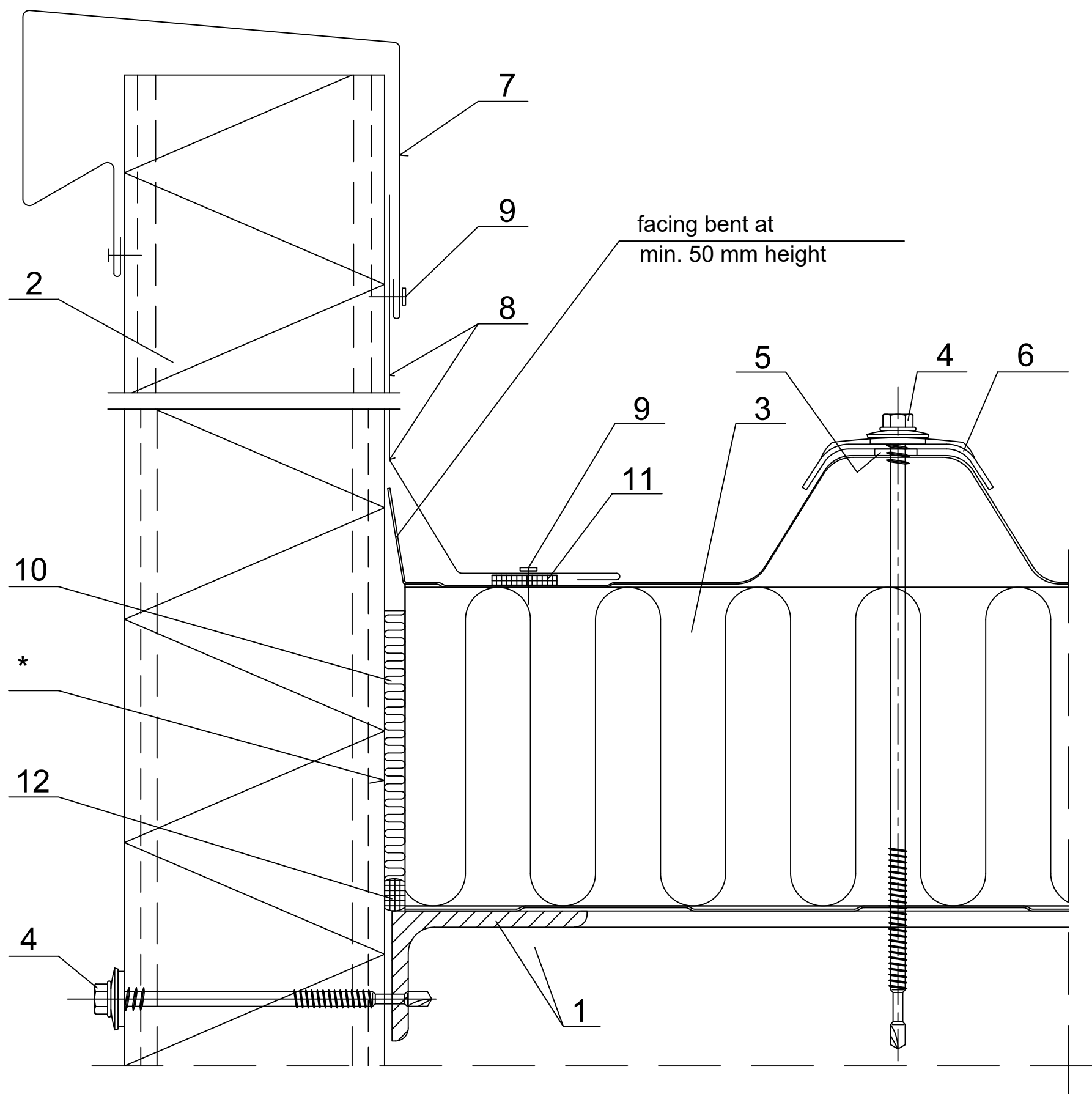

1. Steel elements acc. to engineering design of the structure .
2. Ruukki nSPB W / nSPB WS / nSPB WE / nSPB WF.
3. Ruukki nSPC W.
4. Panel fastener for hot-rolled sheeting rail or for cold-bent sheeting rail
5. 4x20 PIR self-adhesive sealant.
6. Storm washer L06.
7. EA1B06 attic flashing .
8. Custom ordered flashing .
9. Watertight rivet (every 300 mm).
10. Loose mineral wool.
11. Butyl tape .
12. Permanently elastic sealing compound.

\* for structures with high requirements regarding thermal insulation facing gap is ~30 mm; in this case the maximum support length is 300 mm.